

132 133 147 134 135 136 137 138 139 140 141 142 143 144 145 146

KERA.BASE
JUNCTION 45°

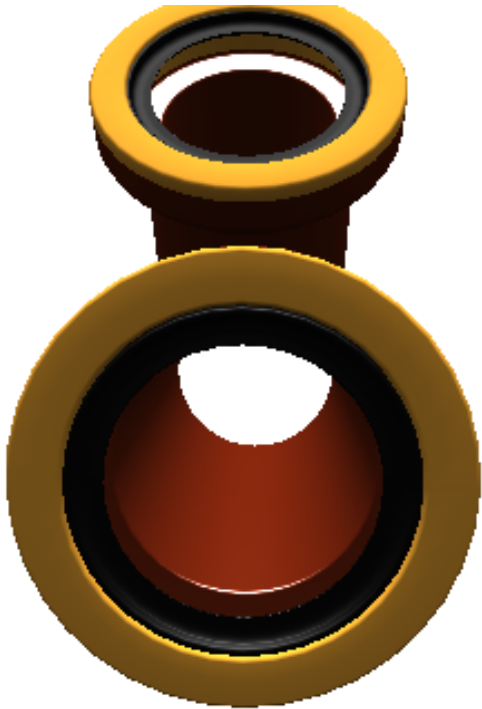

NOMINAL SIZE DN1 200

100

125

150

200

250

300

NOMINAL SIZES DN2

100

125

150

200

JOINT DN1/DN2

KK

LL

KL

JOINT SYSTEM DN1/DN2

CC

FF

CF

LENGTH (CM)

50

WEIGHT	WEIGHT	TKL
32 kg kg/m	32 kg/piece	200/34

MEASUREMENTS

Nominal size	Branch size	Dimensions	
DN 1	DN 2	e max. mm	a max. mm
200	150	85	270

BRIEF DESCRIPTION

Angle ±5°

The dimensions z, a and e are reference values. Other dimensions and crushing strengths: see pipes. The strength class of the branch piece is always normal strength.

Vitrified clay pipes and fittings are standardised in EN 295-1. Supplementary requirements defines the certification program ZP WN 295. All measurements - especially when connecting to other products - must be checked and depend on the specifications of EN 295 and on the certification program ZP WN 295. Subject to technical changes.

